

**PROPOSED GROUND + THREE
STORIED (12.350 M. HEIGHT)
RESIDENTIAL BUILDING AT
PREMISES NO. - 1821, LASKARHAT,
WARD - 107, BR.-XII, K.M.C.
(JADAVPUR UNIT), R.S. DAG
NO.-239(P), R.S. KH. NO. -159, J.L. NO. -
11, MOUZA - LASKARHAT, DISTT. -
24PGS.(S), P.S. - KASBA**

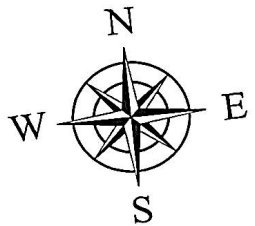
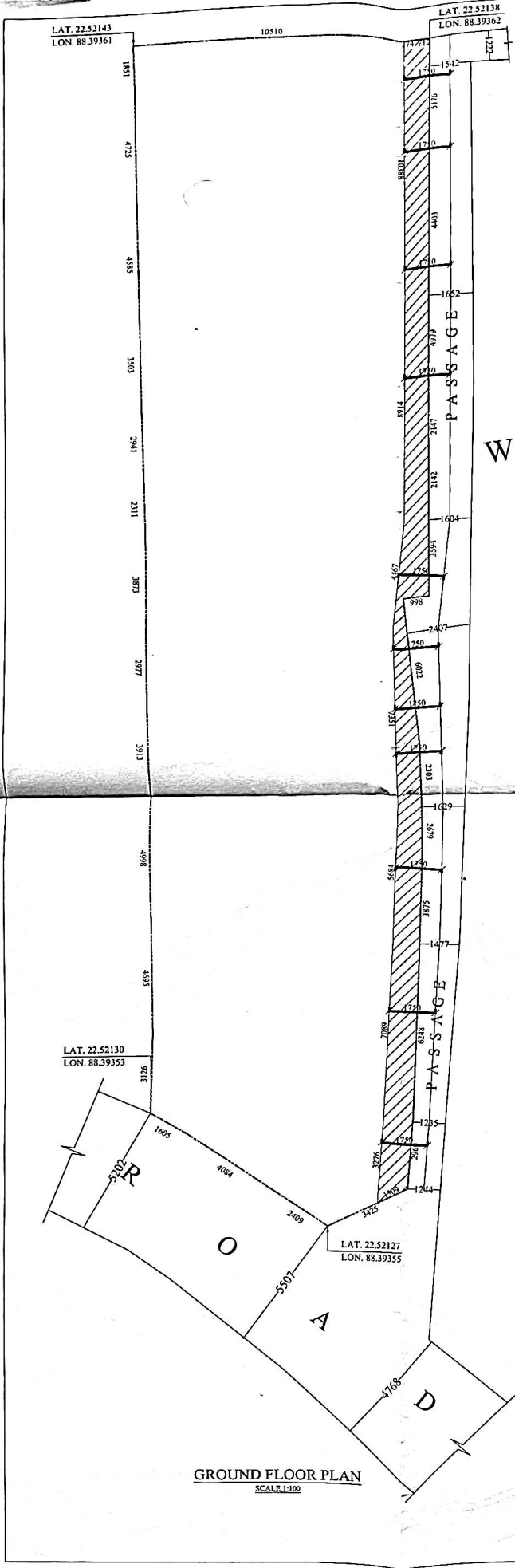

SIGNATURE OF OWNER / S

Suman Mukhopadhyay
SUMAN KR. MUKHOPADHYAY
L.B.S. No.-1141, CLASS-I

SIGNATURE OF L.B.S.